

EXPRESS 200S

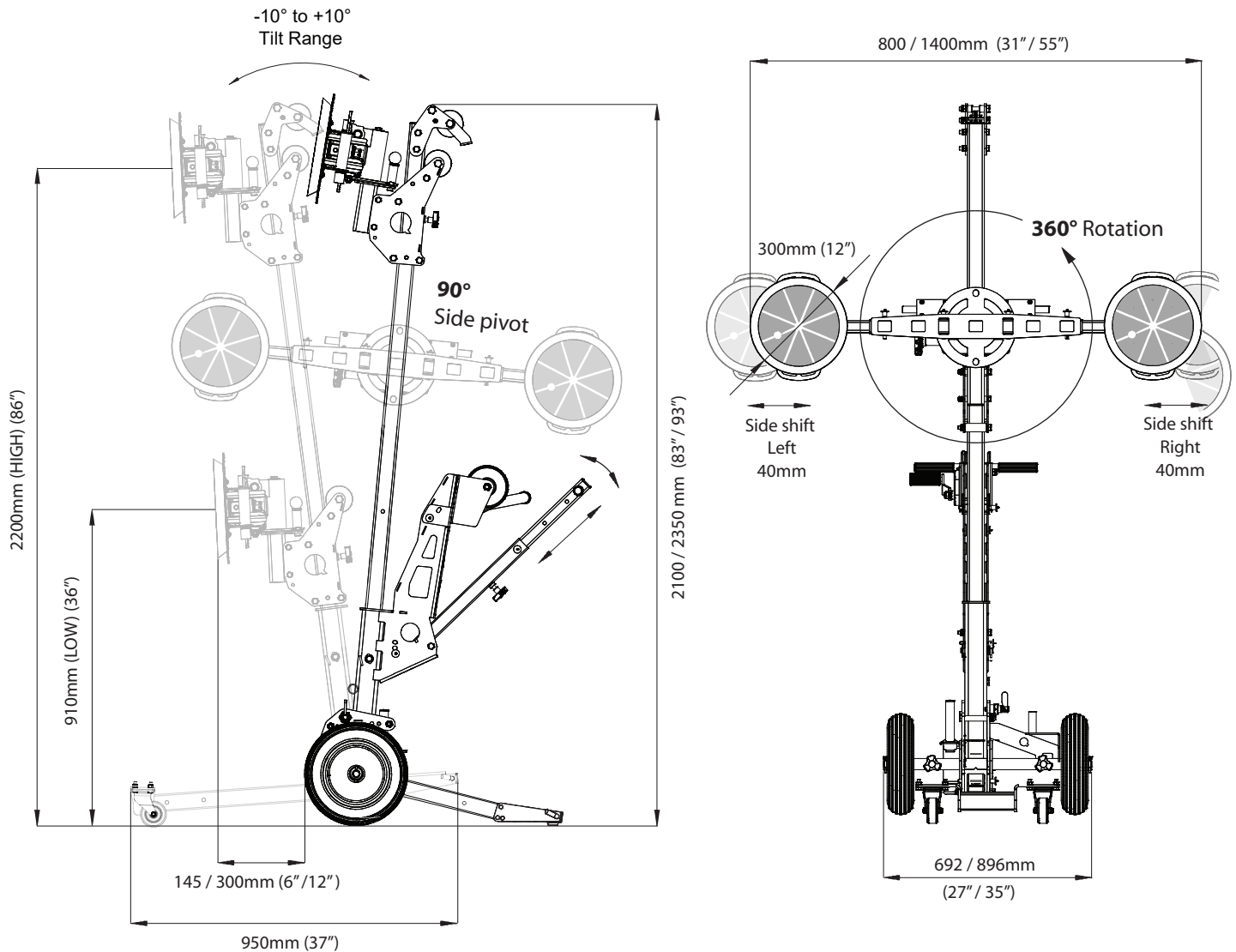

1. Capacity: 200kg (440lbs)	OPTIONS
2. Handles glass to 3660mm (144") x 1500mm (59")	1. Lower forward extension 500mm (20")
3. Front castors retract for glazing	2. Frame lifter for handling windows
4. Vacuum Cups: 2 x 300mm (12")	3. H frame with 4 x 300mm (12") vac cups
5. Solid rear 300mm (12") wheels	4. Battery powered vacuum pump
6. Pivots glass 90° to side for doorways	
7. Mast extends 250mm (10")	
8. Wider axle for greater stability	
9. Side Shift for Glazing (80mm)	
10. Machine Weight with Vacuum Cups Removed - Top half 32kg (70 lbs) and Bottom half 20kg (44 lbs)	